

尺寸范围	未注公差值
0~3	±0.1
3~6	±0.15
6~9	±0.2
9~12	±0.25
12~15	±0.3

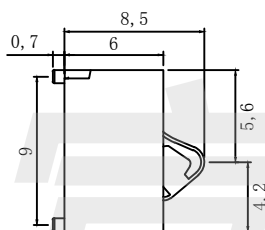

### SPECIFICATIONS

- ELECTRICAL CHARACTERISTICS:
  - RATING: DC 12V 2A
  - CONTACT RESISTANCE: 20mΩ MAX(INITIAL)
  - DIELECTRIC WITHSTANDING VOLTAGE: 500V AC FOR ONE MINUTE
  - INSULATION RESISTANCE: 100MΩ MIN, MEASURED BY 500V DC
- LIFE TEST: MECHANICAL LIFE TEST 10,000 CYCLES.

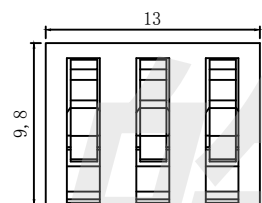
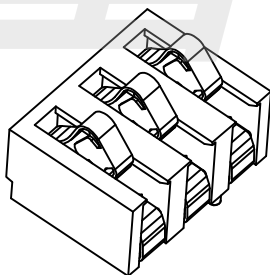
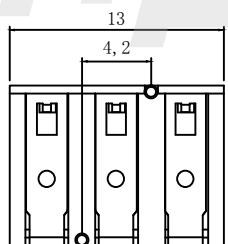

2	1#脚	3	不锈钢	镀金	国产
1	基座	1	LCP	白色	国产
序号	名称	数量	材料	颜色	备注
NO.	DESCRIPTION	Q'TY	MATERIAL	COLOR	REMARK

HAOFU ELECTRONICS TECHNOLOGY CO.,LTD

COPYRIGHT RESERVED PLEASE DO NOT COPY.

PART NAME		CONNECTOR		DRAWING	Y,C,ZHANG	DWG.No.	SBICL	
PART NO.		BC3P42H85D		CHECK	G.C.Chen	REV.	A1	
	UNIT :	TOLERANCE OTHERWISE	UP TO 5	±0.2	ANGLE 0°±3°	APPROVAL	DATE	26-07-2013
	mm		ABOVE 5~30	±0.3		SCALE	2:1	PAGE
			ABOVE 30	±0.5				
			ANGLE	±3°				