

推荐PCB版布局

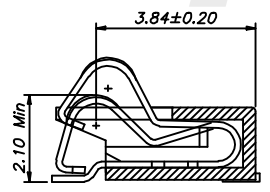
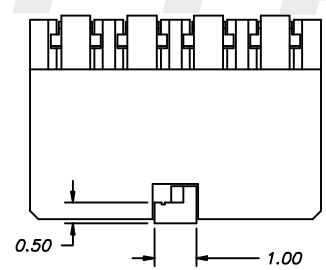
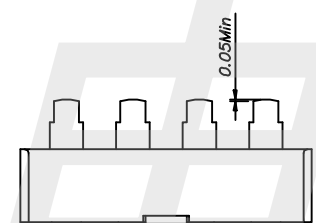
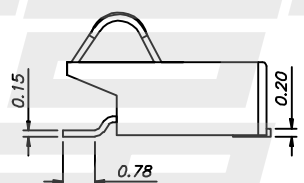
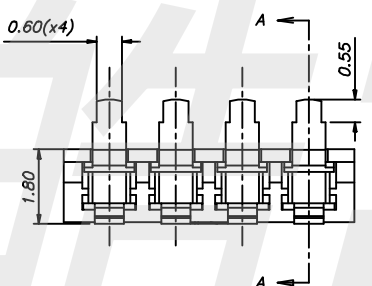

③	端子	铜合金
②	固定脚	铜合金
①	胶壳	LCP
编号	名称	材质

- 注:
1. 材质
A. 端子: 铜合金
B. 胶壳: 耐高温热塑性塑料. UL94V-0, 黑色.
 2. 电镀: A: 端子:接触区域镀金
B: 固定脚: 20-200u" (1.27-5.08u) 雾锡, 50-100u" (1.27-2.54u) 镍低;
 3. 电性能要求:
操作电压: 250 VAC MIN
操作电流: 2.0 A MIN
耐电压: 1000 VAC FOR 1 MINUTE MIN
绝缘强度: 1000 MEG OHM MIN
接触电阻: 30 MILL. OHM MAX
工作温度: -55° TO +125° C
产品可抗: 260° 持续10秒的SMT 回流焊制程.
 4. 机械性能要求:
压缩寿命: 5.000 次;
工作位置端子弹力: 80 MIN/Pin

HAOFU ELECTRONCS TECHNOLOGY CO.,LTD

COPYRIGHT RESERVED,PLEASE DO NOT COPY.

PART NAME		CONNECTOR		DRAWING	Y,C,ZHANG	DWG.No.	SBICL
PART NO.		BC4P16H30		CHECK	G.C.Chen	REV.	A1
UNIT : mm	TOLERANCE OTHERWISE	UP TO 5	±0.2	ANGLE	APPROVAL	DATE	25-04-2017
		ABOVE 5~30	±0.3				
		ABOVE 30	±0.5	0°±5'	SCALE	PAGE	1 OF 1
		ANGLE	±3'				