

RoHS  
Compliant

性能:

- 额定电流: 2.0A
- 额定电压: 12V
- 耐电压: 500V
- 接触电阻: 30mΩ
- 绝缘电阻: 500MΩ
- 工作温度: -40℃~+85℃
- 使用寿命: 5000次以上
- 塑件(材质): LCP(黑色) UL94-V0
- 接触点(材质): 锡磷青铜, 触点镀金3U", 焊脚镀金1U", 镍30-80U"
- 固定片(材质): 黄铜C2680, 镀全雾锡70U"以上, 镍底30-80U"
- 环保要求: 符合ROHS限值。

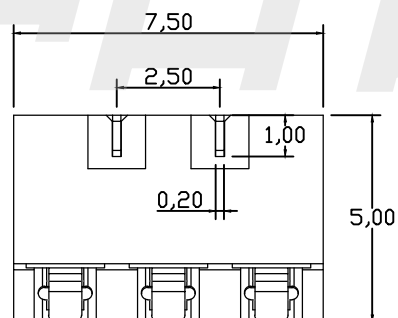
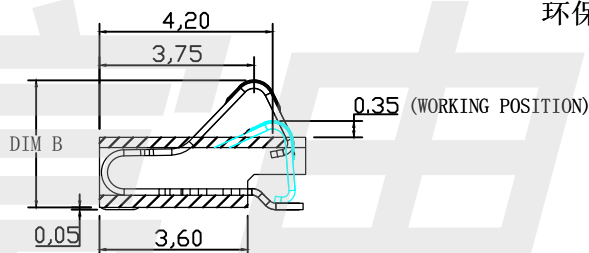
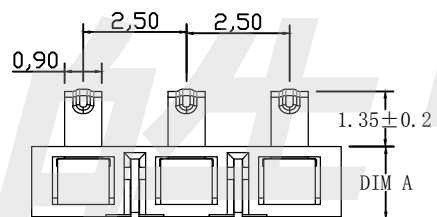
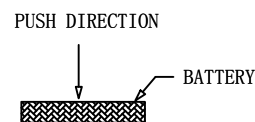
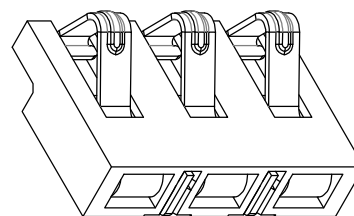
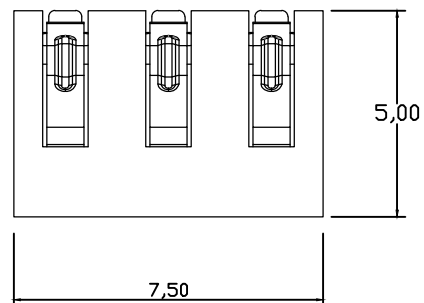

PART NO.	DIM A	DIM B
BC3P25H305	1.7	3.05 ± 0.2
BC3P25H335	2.0	3.35 ± 0.2

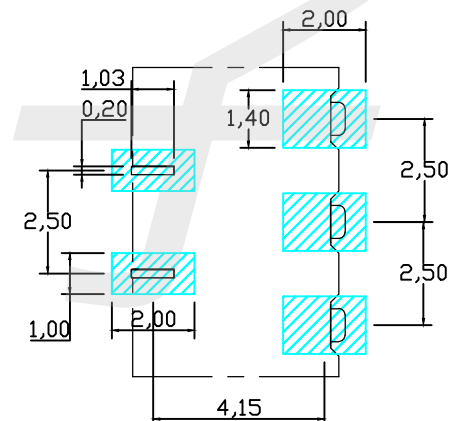

RECOMMENDED PCB LAYOUT  
TOP VIEW (.XX ± 0.05)

HAOFU ELECTRONICS TECHNOLOGY CO.,LTD

COPYRIGHT RESERVED,PLEASE DO NOT COPY.

PART NAME		CONNECTOR		DRAWING	Y,C,ZHANG	DWG.No.	SBICL
PART NO.		BC3P25H305		CHECK	G.C.Chen	REV.	A1
UNIT : mm	TOLERANCE OTHERWISE	UP TO 5	±0.2	ANGLE	APPROVAL	DATE	23-08-2019
		ABOVE 5 ~ 30	±0.3			PAGE	1 OF 1
		ABOVE 30	±0.5	0°±3'	SCALE	2:1	