

PART No.	PIN	A	B	C
CL-038-6P	6P	17.8	17	15.4
CL-038-4P	4P	12.8	12	10.4

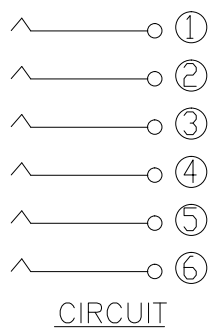

性能:
 额定电流: 2.0A
 额定电压: 12V
 耐电压: 500V
 接触电阻: 30mΩ
 绝缘电阻: 500MΩ
 工作温度: -40℃~+85℃
 塑件(材质): LCP
 接触点(材质): 磷铜, 镀金

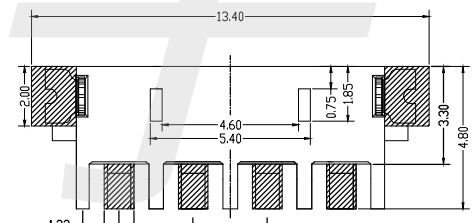
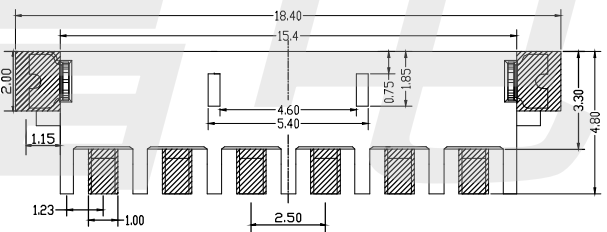
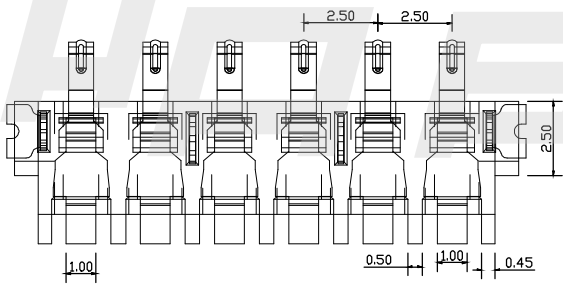
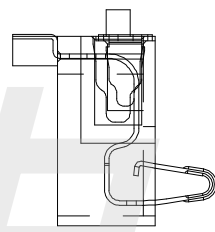
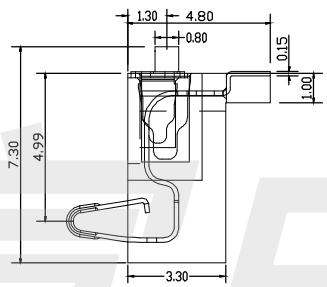
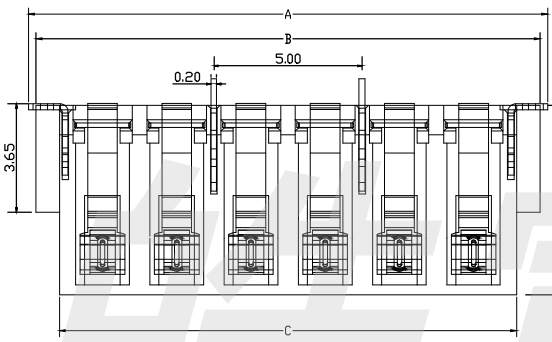

3	PEG	BRASS	1	Sn PLATED
2	HOUSING	LCP	1	BLACK
1	TERMINAL	C5210	6	Au PLATED
NO.	PARTS	MATERIAL	QTY.	FINISHING

HADFU ELECTRONICS TECHNOLOGY CO.,LTD

COPYRIGHT RESERVED,PLEASE DO NOT COPY.

PART NAME		CONNECTOR		DRAWING	Y,C,ZHANG	DWG.No.	SBICL
PART NO.		CL-038		CHECK	G.C.Chen	REV.	A1
UNIT : mm	TOLERANCE	UP TO 5	±0.2	APPROVAL	SCALE	DATE	14-03-2013
	OTHERWISE	ABOVE 5~30	±0.3			PAGE	1 OF 1
		ANGLE	0°±3'				