

ELECTRICAL CHARACTERISTICS

1. RATING: DC 50V 0.5A
2. CONTACT RESISTANCE: 100mΩ MAX
3. INSULATION RESISTANCE: 100MΩ MIN
4. DIELECTRIC STRENGTH: AC 250V(50~60Hz)/60S

MECHANICAL CHARACTERISTICS

1. PRACTICAL TEMPERATURE RANG: -40℃~+85℃
2. OPERATING FORCE: 180±50gf
3. MECHANICAL LIFE: 30,000 cycles

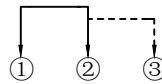
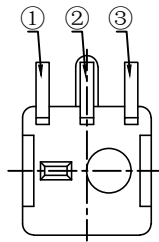
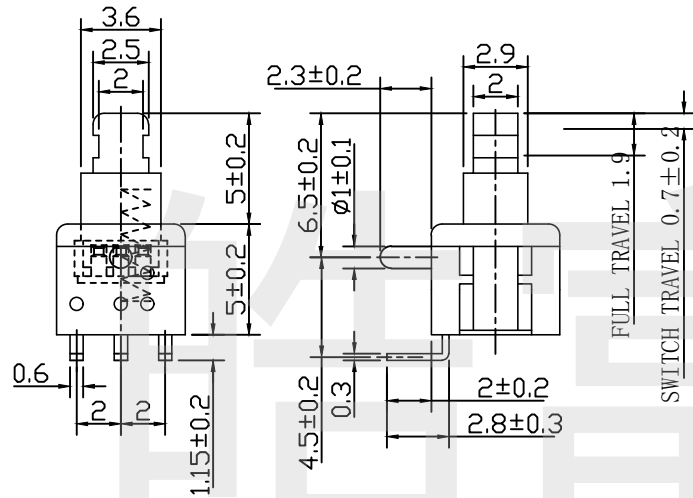

SCHEMATIC

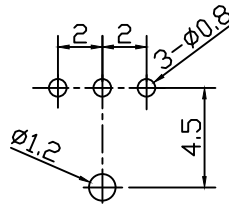

P. C. B LAYOUT

NO.	PART NAME	MATERIAL	QTY.	FINISHING
8				
7				
6	TERMINAL	BRASS STRIP	3	Ag PLATED
5	CASE	PA66	1	GRAY
4	SPRING	SUS WIRE	1	NATURAL
3	CONTACT	PBS	1	Ag PLATED
2	KNOB	PA66	1	GRAY
1	COVER	PBT	1	BLACK

HAOFU ELECTRONCS TECHNOLOGY CO., LTD

PART NAME		PUSH SWITCH		DRAWING	Y,C,ZHANG	DWG.No.	SBICL
PART NO.		PB22E62NL		CHECK	G.C.Chen	REV.	A1
UNIT :	TOLERANCE	UP TO 5	ABOVE 5~30	ANGLE	APPROVAL	DATE	
mm	OTHERWISE	±0.2	±0.3	0°±3'	SCALE	PAGE	1 OF 1
		±0.5	±3'		2:1		

COPYRIGHT RESERVED,PLEASE DO NOT COPY.