

主要技术性能

1. 额定电负荷：30V 1.0A;
2. 接触电阻： $\leq 0.03$ ；
3. 绝缘电阻： $\geq 100M$ ；
4. 耐压：AC500V(50Hz)min;
5. 插拔力：3-15N;
6. 寿命：5,000次。

主要技术要求

1. 未注线性公差：
 

0.0-10.0mm	$\pm 0.10mm$
10.0-20.0mm	$\pm 0.15mm$
20.0-50.0mm	$\pm 0.20mm$
2. 外观应良好，无锈蚀、裂痕、电镀不良等现象。

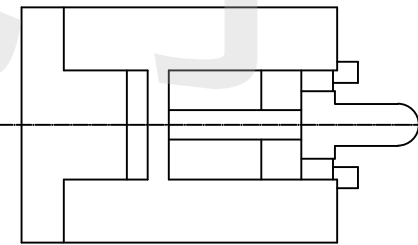
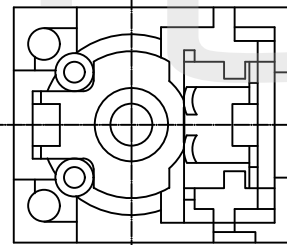
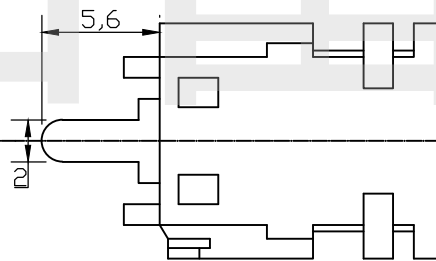
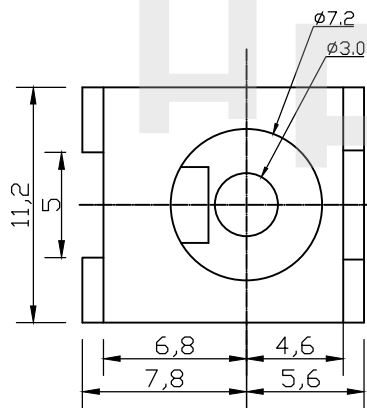
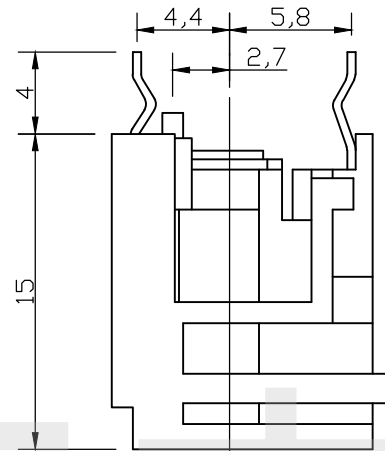
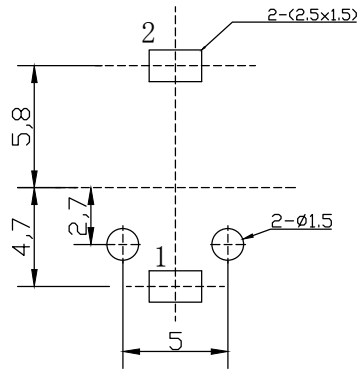
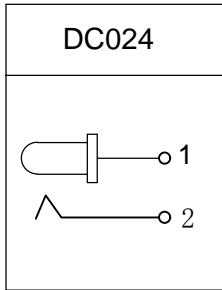

HADFU ELECTRONCS TECHNOLOGY CO.,LTD

COPYRIGHT RESERVED,PLEASE DO NOT COPY.

PART NAME		DC POWER JACK		DRAWING	G.C.Chen	DWG.No.	
PART NO.		DC-024		CHECK	G.C.Chen	REV.	A
UNIT : mm	TOLERANCE	UP TO 10	$\pm 0.1$	ANGLE	APPROVAL	DATE	
	OTHERWISE	ABOVE 10~ 20	$\pm 0.15$			SCALE	2:1
		ABOVE 20~ 50	$\pm 0.2$	$\sigma \pm 3^\circ$			