

A向24° a与b通

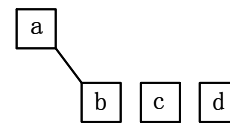

B向24° a与d通

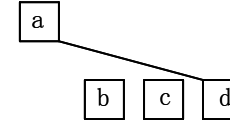

C向150g  
a与c通

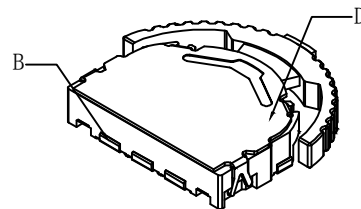
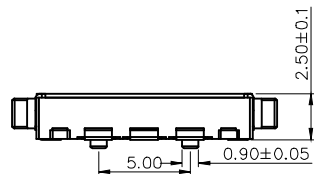
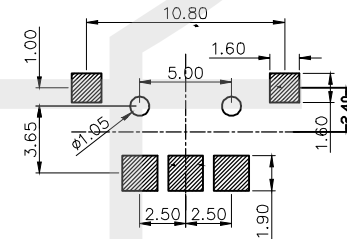
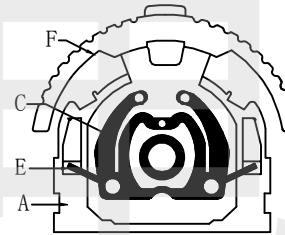
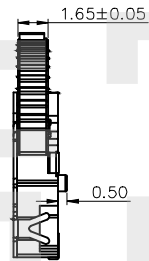
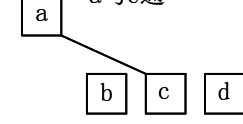

材料:

- A基 座: 尼龙 (黑色)
- B卡 件: 磷铜 (银白色与镀银)
- C簧 片: 复银铜 (白色)
- D盖 子: 不锈钢 (原色)
- E弹 簧: 不锈钢丝 (原色)
- D手 柄: 尼龙 (黑色)

主要技术规格:

1. 额 定 值: 0.1A DC12V
2. 接 触 电 阻: 100mΩ
3. 操 作 力: 80gf±50gf
4. 行 程: 1.0±0.2mm
5. 绝 缘 电 阻: 100MΩ
6. 抗 电 强 度: 110V 50HZ 1Min.
7. 寿 命: 10万Cycles

HADFU ELECTRONCS TECHNOLOGY CO.,LTD

COPYRIGHT RESERVED,PLEASE DO NOT COPY.

PART NAME		MULTI FUNCTION SWITCH		DRAWING		Y,C,ZHANG	DWG.No.	SBICL
PART NO.		MT-007		CHECK		G.C.Chen	REV.	A1
UNIT : mm	TOLERANCE	UP TO 5	±0.2	ANGLE	APPROVAL	DATE		
	OTHERWISE	ABOVE 5~30	±0.3			SCALE	2:1	PAGE
		ABOVE 30	±0.5	σ±3°				
		ANGLE	±3°					